

DESIGNER SERIES DRAWERS INSTALLATION GUIDE

TECHINICAL SUPPORT
888-934-9449 Press 1
 SERVICE@SUNSTONEMETALPRODUCTS.COM

Designer Series Doors & Drawers are configurable both Vertically & Horizontally, follow these steps for proper installation. Designer Series Components are designed to Match with our Stainless Steel Cabinet Islands.

PLACING:

All Designer Drawers are "Self-Rimming", meaning that whatever the Cut-Out edge looks like, as it is always rough, the product rim will cover all edges. Specific to Designer Drawers, see the adjustable Legs with Rubber Footings located at the Back of Drawer Box.

See Leveling Leg locating in back of Drawer Box, after Drawers are removed, reach into empty box to Turn Bolts down-wards in order to drop Leveling Leg Down for each Side

Adjust Leveling Leg Down to floor base or place brick beneath leg if Drawer Box is positioned high.

EXAMPLE: PLACING

MOUNTING:

Start by removing ALL drawers by locating the small Black Lever on the Left & Right Drawer Track while drawer is fully extended. Lift UP on the Left Lever while Pushing Down on the Right Lever and slide drawer completely out. Locate the "Pre-Drilled" Holes on the Left and Right sides. You will need to use correct screw to properly secure to island frame per construction type. If Drawer box is still not Level - continue adjusting the two leveler bolts in back, also we suggest using a "Leveler" to find the exact Horizontal Line.

EXAMPLE: MOUNTING

ADJUSTING:

Check the Alignment of the Drawer Box that is Horizontal, add additional Shimming in back of box if needed. If you have not already installed the Handles - Please do that now, handles come packaged pinned inside the drawer face, you may need to reverse them using a Screw Driver.

If any other the drawer face panels are not aligned Horizontal, this will prevent drawer from closing properly. Locate the two screws on the Left & Right sides behind drawer panel, looses slightly to re-align drawer face panel.

See Screws on front panels, need to unscrew from inside and fasten on front drawer face

EXAMPLE: ADJUSTING

REFER TO YOUR INDIVIDUAL PRODUCT SPECIFICATION SHEET THAT CAME WITH YOUR SUNSTONE PRODUCT

CUT-OUT DEPTH THE DEPTH OF DRAWER BOX NOT INCLUDING THE FRONT DRAWER PANEL AND DRAWER FRAME

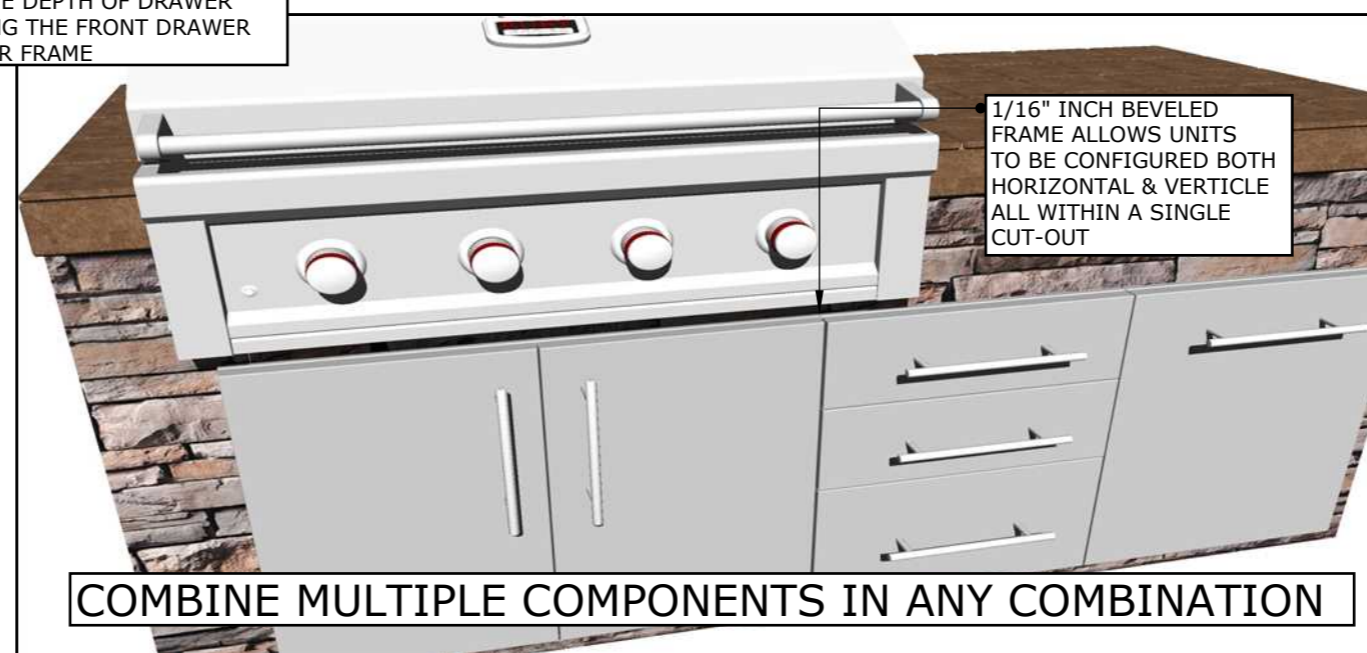
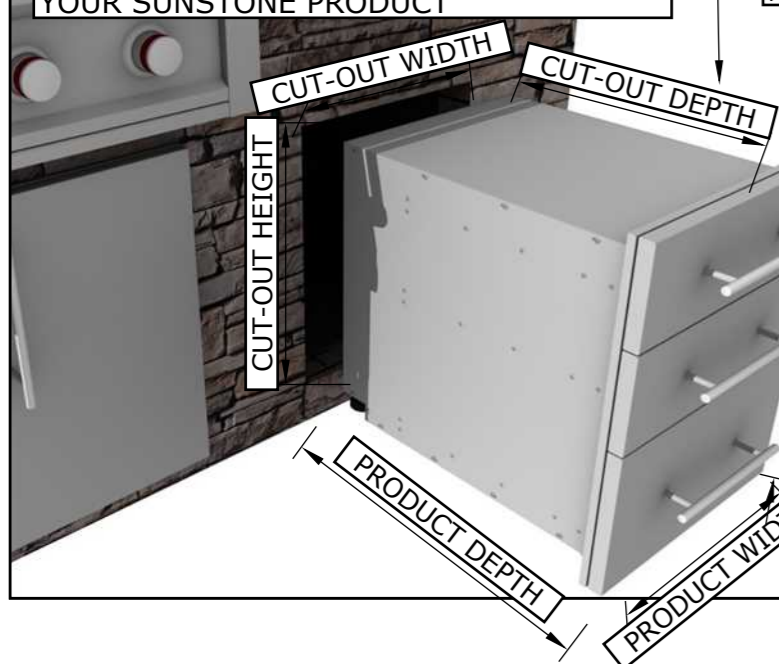

COMBINE MULTIPLE COMPONENTS IN ANY COMBINATION

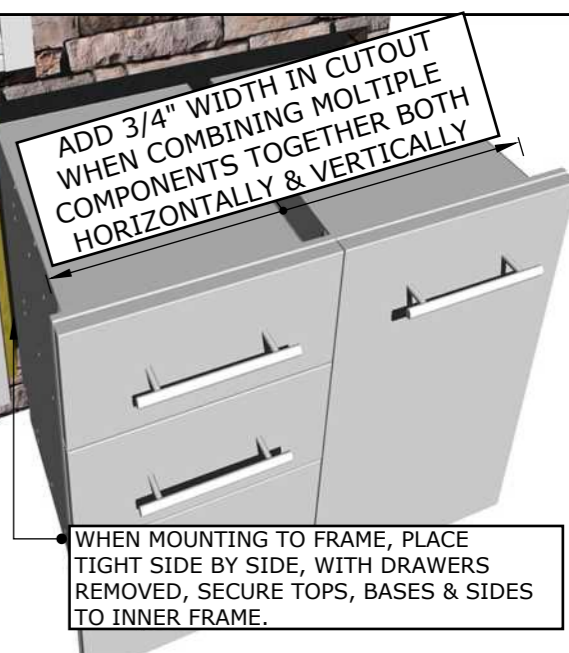

WHEN MOUNTING TO FRAME, PLACE TIGHT SIDE BY SIDE, WITH DRAWERS REMOVED, SECURE TOPS, BASES & SIDES TO INNER FRAME.